



# CH-2D3D

2D to 3D Converter



Operation Manual





## **DISCLAIMERS**

The information in this manual has been carefully checked and is believed to be accurate. Cypress Technology assumes no responsibility for any infringements of patents or other rights of third parties which may result from its use.

Cypress Technology assumes no responsibility for any inaccuracies that may be contained in this document. Cypress also makes no commitment to update or to keep current the information contained in this document.

Cypress Technology reserves the right to make improvements to this document and/or product at any time and without notice.

## **COPYRIGHT NOTICE**

No part of this document may be reproduced, transmitted, transcribed, stored in a retrieval system, or any of its part translated into any language or computer file, in any form or by any means—electronic, mechanical, magnetic, optical, chemical, manual, or otherwise—without express written permission and consent from Cypress Technology.

© Copyright 2011 by Cypress Technology.

All Rights Reserved.

Version 1.1 August 2011

## **TRADEMARK ACKNOWLEDGMENTS**

All products or service names mentioned in this document may be trademarks of the companies with which they are associated.



## SAFETY PRECAUTIONS

Please read all instructions before attempting to unpack, install or operate this equipment and before connecting the power supply.

Please keep the following in mind as you unpack and install this equipment:

- Always follow basic safety precautions to reduce the risk of fire, electrical shock and injury to persons.
- To prevent fire or shock hazard, do not expose the unit to rain, moisture or install this product near water.
- Never spill liquid of any kind on or into this product.
- Never push an object of any kind into this product through any openings or empty slots in the unit, as you may damage parts inside the unit.
- Do not attach the power supply cabling to building surfaces.
- Use only the supplied power supply unit (PSU). Do not use the PSU if it is damaged.
- Do not allow anything to rest on the power cabling or allow any weight to be placed upon it or any person walk on it.
- To protect the unit from overheating, do not block any vents or openings in the unit housing that provide ventilation and allow for sufficient space for air to circulate around the unit.

## REVISION HISTORY

VERSION NO.	DATE DD/MM/YY	SUMMARY OF CHANGE
VS1	25/11/11	First release

## CONTENTS

<b>1. Introduction</b> .....	<b>1</b>
<b>2. Applications</b> .....	<b>1</b>
<b>3. Package Contents</b> .....	<b>1</b>
<b>4. System Requirements</b> .....	<b>1</b>
<b>5. Features</b> .....	<b>1</b>
<b>6. Operation Controls and Functions</b> .....	<b>2</b>
6.1 Front Panel .....	2
6.2 Rear Panel.....	3
<b>7. Connection Diagram</b> .....	<b>4</b>
<b>8. Specifications</b> .....	<b>5</b>
<b>9. Acronyms</b> .....	<b>5</b>



## 1. INTRODUCTION

The 2D to 3D Converter offers real-time conversion of 2D content into 3D. Using this device you can easily create a 3D video using 3D TV/ display. Instead of purchasing expensive 3D DVDs, this device allows you to convert 2D formats into 3D formats, for instance 2D content to SBS (Side-by-side Half).

## 2. APPLICATIONS

- Home entertainment
- Showroom environments

## 3. PACKAGE CONTENTS

- 2D to 3D Converter
- 5V/2.6A DC power adaptor
- User Manual

## 4. SYSTEM REQUIREMENTS

2D Blu-ray or DVD Player with HDMI/DVI output and 3D HDTV with HDMI display.

## 5. FEATURES

- Supports 2D to 3D Side-by-Side (Half)- (SBSH)
- Up to 1080p@60Hz/24Hz and 720p@60Hz 8-bits
- Supports interlace input bypass but does not support 2D to 3D
- Supports automatic 3D bypass

## 6. OPERATION CONTROLS AND FUNCTIONS

### 6.1 Front Panel

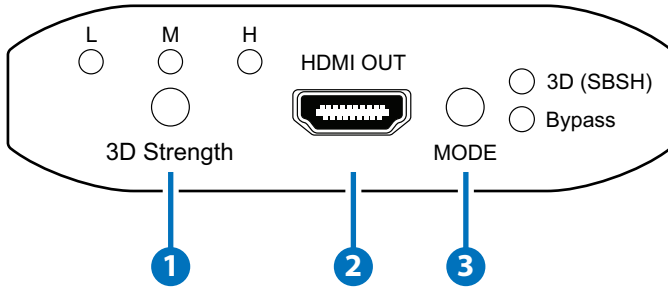

#### 1 3D Strength

Press to select 3D image strength (Low/Middle/High).

#### 2 HDMI OUT

HDMI output to connect to the 3D ready HDMI display.

#### 3 Mode Select

- Press the mode button to select SBS 3D (SBSH) or bypass mode.
- If no picture is displayed, please check the TV's 3D setting is on SBSH or select bypass mode.
- Bypass Mode: Supports 3D Resolution

FRAME PACKING	SIDE BY SIDE HALF(SBSH)	TOP & BOTTOM
1080p@30	1080p@60	1080p@60
1080p@24	1080p@50	1080p@50
720p@60	1080i@60	1080p@24
720p@50	1080i@50	720p@60
	720p@60	720p@50
	720p@50	720p@30

## 6.2 Rear Panel

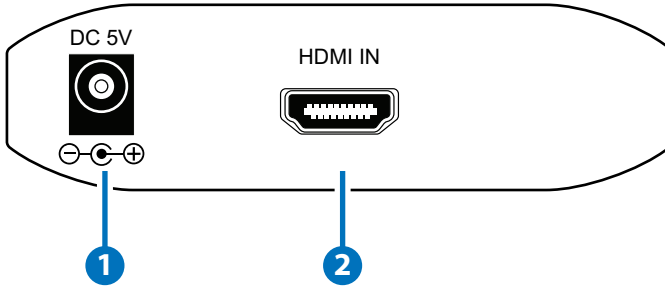

### 1 DC 5V

Plug the 5V DC power supply into the unit and connect the adaptor to an AC wall outlet.

### 2 HDMI IN

Connect the HDMI output of the 2D source the HDMI IN connector.



## 7. CONNECTION DIAGRAM

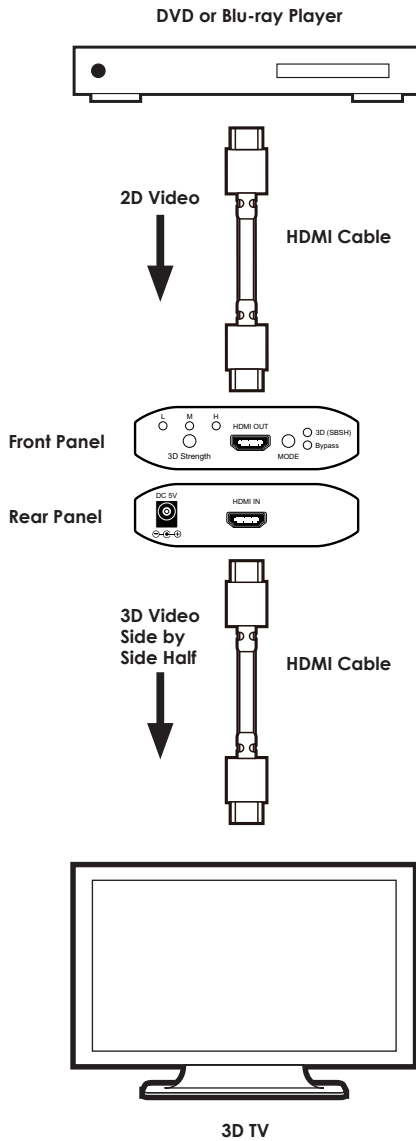



## 8. SPECIFICATIONS

<b>TMD5 Clock Frequency</b>	148.5 MHz
<b>Color Depth</b>	8-bit
<b>Color Space</b>	4:2:2 YUV, RGB
<b>Input Port</b>	1 × HDMI
<b>Output Port</b>	1 × HDMI
<b>Bypass Resolution</b>	480i, 480p@60, 576i, 576p@50, 720p@60, 720p@50, 1080i@50, 1080i@60, 1080p@24, 1080p@50, 1080p@60
<b>2D to 3D Support Resolution</b>	720p@60, 1080p@24, 1080p@60
<b>Power Supply</b>	5V/2.6 A DC (US/EU standards, CE/ FCC/UL certified)
<b>Dimensions</b>	90 mm (W) × 120 mm (D) × 25 mm (H)
<b>Chassis Material</b>	Plastic
<b>SilkScreen Color</b>	Black
<b>Weight</b>	100g
<b>Operating Temperature</b>	0°C~40°C/ 32°F~104°F
<b>Storage Temperature</b>	-20°C~60°C/-4°F~140°F
<b>Relative Humidity</b>	20~90% RH (non-condensing)
<b>Power Consumption</b>	3.8 W

## 9. ACRONYMS

ACRONYM	COMPLETE TERM
3D	3 Dimensional
HDMI	High-Definition Multimedia Interface
SBSH	Side-By-Side Half





**CYPRESS TECHNOLOGY CO., LTD**

Home page: <http://www.cypress.com.tw>